

Banquet

Hall

Guide

美のおもてなし。

 国立京都国際会館

交流の舞台はクライマックスへ。
緊張感が満足感に変わるとき、
人は明日への想いを語り合う。

As the event reaches its climax,
anticipation comes to fruition,
and conversations turn to hopes and dreams.

開館以来50年、コンベンションのケータリングを数多く手がけ、国内外から多彩なゲストをお迎えして参りました。このたび、ニューホール開業を機に、規模やスタイル等のご利用シーンに合わせ、より幅広いラインナップから会場をお選び頂けるようになりました。心を込めた「食のおもてなし」で、記憶に残る「ひととき」を演出いたします。

In the 50 years since we first opened, we have handled catering for numerous conventions, and welcomed various VIPs and special guests from all over the world. Now, with the opening of New Hall, we are able to offer a diverse lineup of venues from which you can choose the size, style and so forth that suit the occasion. With our heartfelt hospitality, we deliver delightful dining experiences that make events unique and unforgettable.





New Hall



「えらべる」ケータリングサービス
Your Choice catering service

“京都らしさ”の粋を集めたしつらえ。
会場そのものが思い出となる、
伝統×先進のホール。

Furnishings and décor reflect the stylish Kyoto aesthetic.
The hall blends tradition and innovation in a venue
that will linger in guests' memories.

New Hall Sample Layouts Area: 2,000m²

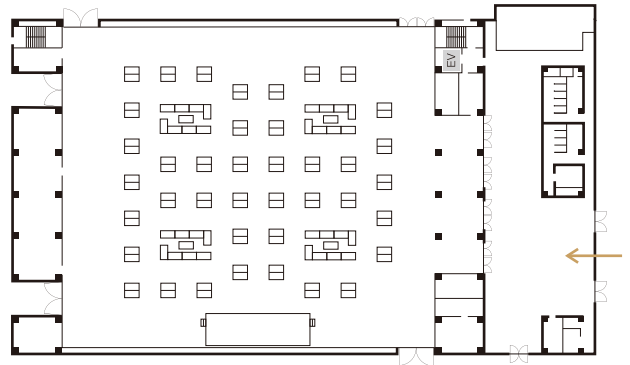

Reception | 1,500

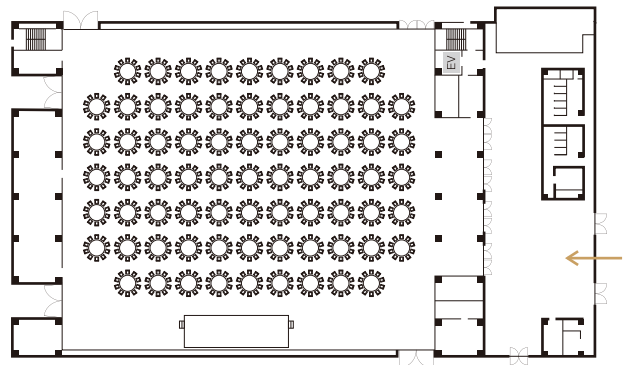

Banquet | 730





New Hall Approach



New Hall Approach



New Hall Foyer



Event Hall



「えらべる」ケータリングサービス
Your Choice catering service

昇降式ステージを備え、
19mの天井高さを誇る無柱空間。
大規模パーティーの実績が豊富な、
京都最大級のホール。

The vast, pillar-less open space with a lofty ceiling height of
19 meters features an elevating stage.
This is among Kyoto's largest halls,
with an extensive track record of hosting large parties.



Event Hall Sample Layouts
Area: 3,000m²

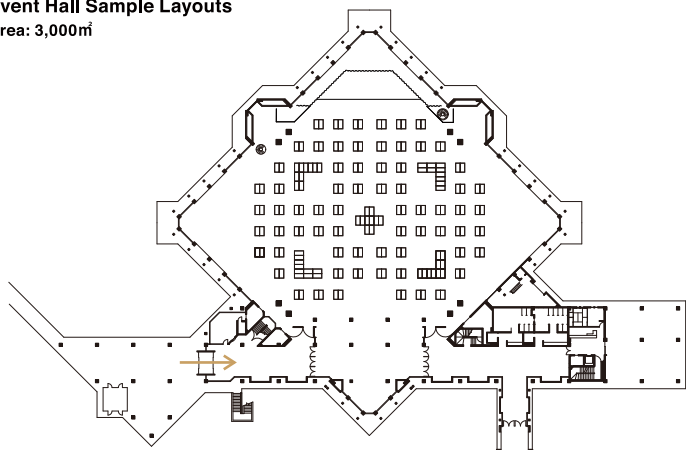

Reception | 2,000

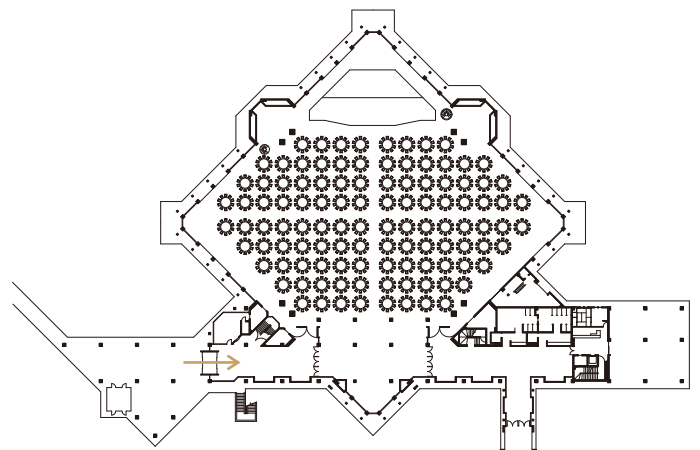

Banquet | 1,100



Annex Hall

可動式間仕切りも備えた柔軟性の高いホール。
ロビーには、日本庭園に面した
ゆとりある空間が広がります。

A soundproofing partition makes this hall highly versatile.
The spacious lobby has a lovely view
overlooking a Japanese garden.

Annex Hall Sample Layouts
Area: 1,500m²

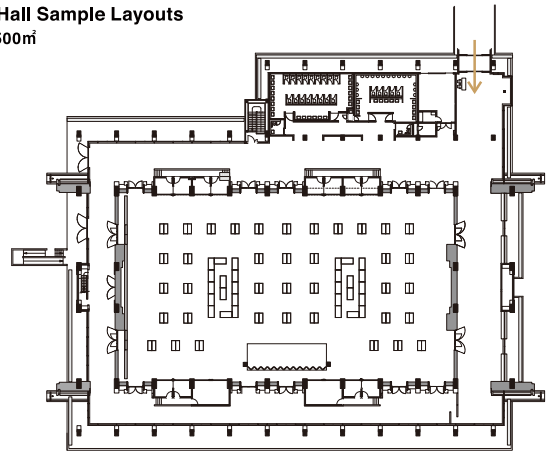

Reception | 1,000



7

Lobby

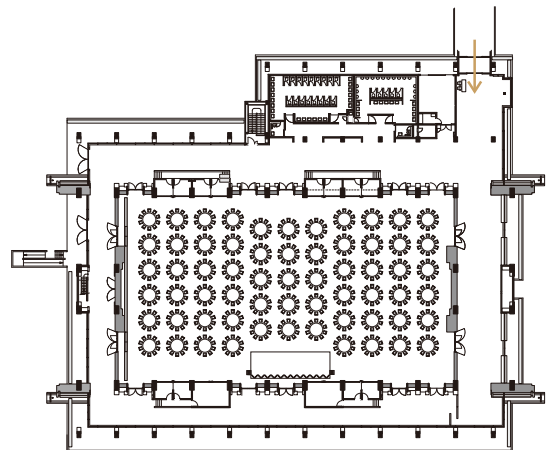

Banquet | 630



Sakura

比叡山を望むガラス張りの宴会場。
春には庭園のさくらが
世界中のゲストを魅了します。

A glass-enclosed banquet hall with a panoramic view of Mt. Hiei.
It can be used in combination with the terrace, and in the spring,
cherry blossoms in the garden delight guests all over the world.

Sakura Sample Layouts
Area: 805m²

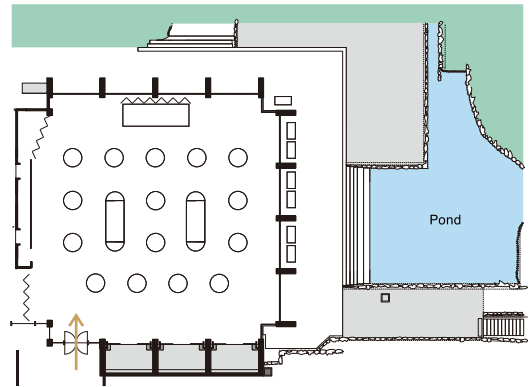

Reception | 500

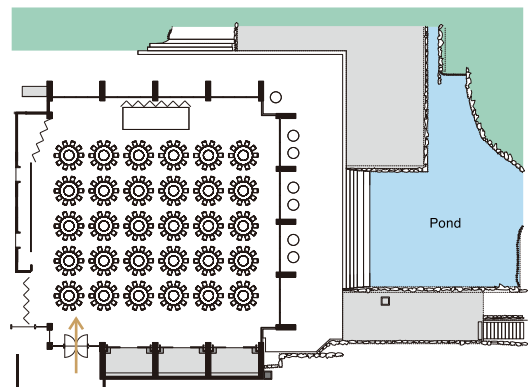

Banquet | 300



Japanese Garden

四季折々の自然美に彩られる庭園。
日没後は、幻想的な雰囲気が漂う
特別なパーティースペースに。

The natural beauty of the traditional-style Japanese garden changes with the seasons.
After sunset, it becomes a one-of-a-kind party venue with a truly magical atmosphere.





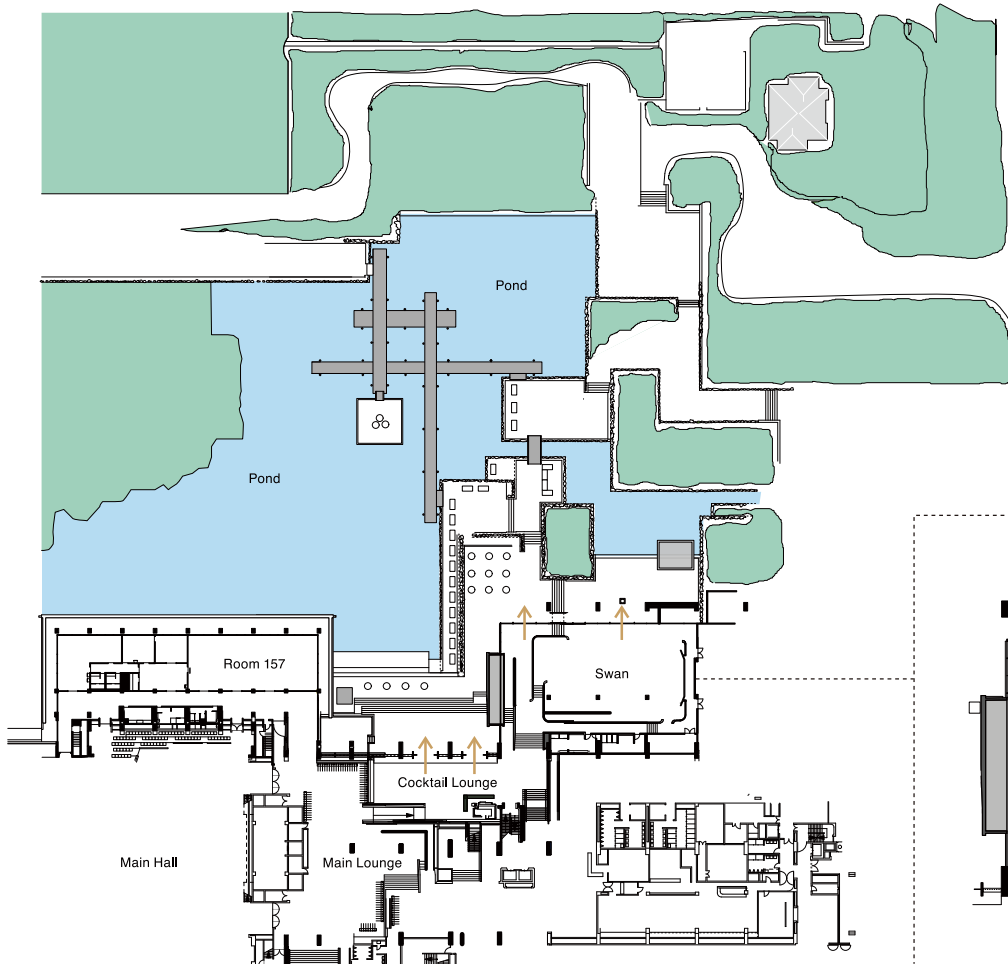

Japanese Garden Sample Layouts
Area: 5,000㎡

Reception | 2,000

Swan Sample Layouts
Area: 540㎡

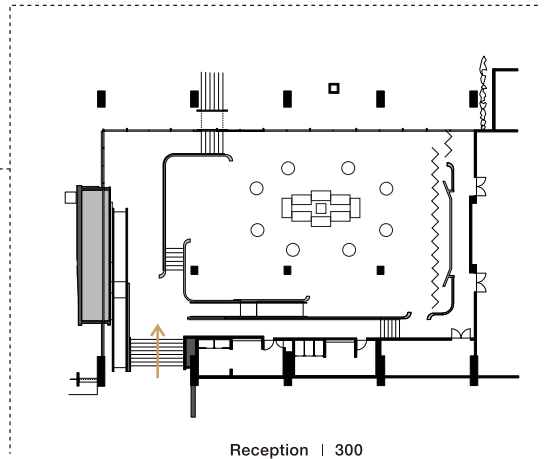

Reception | 300

Swan

庭園を見渡せる開放的な空間で
フロアがすべて板張りの宴会場。
庭園とラウンジを合わせて、
京都最大級の3,000名規模の
ガーデンパーティーにも対応します。

Swan is an expansive banquet hall entirely done in wood,
with a lovely view of the garden.
Together with the garden and the lounge,
it has a capacity of 3,000 guests,
making it one of Kyoto's largest venues for a garden party.



Main Lounge



Swan

館内のご案内
Our Facilities

New Hall・Event Hallゾーン
New Hall and Event Hall Zone

本館ゾーン
Main Building Zone

Annex Hallゾーン
Annex Hall Zone

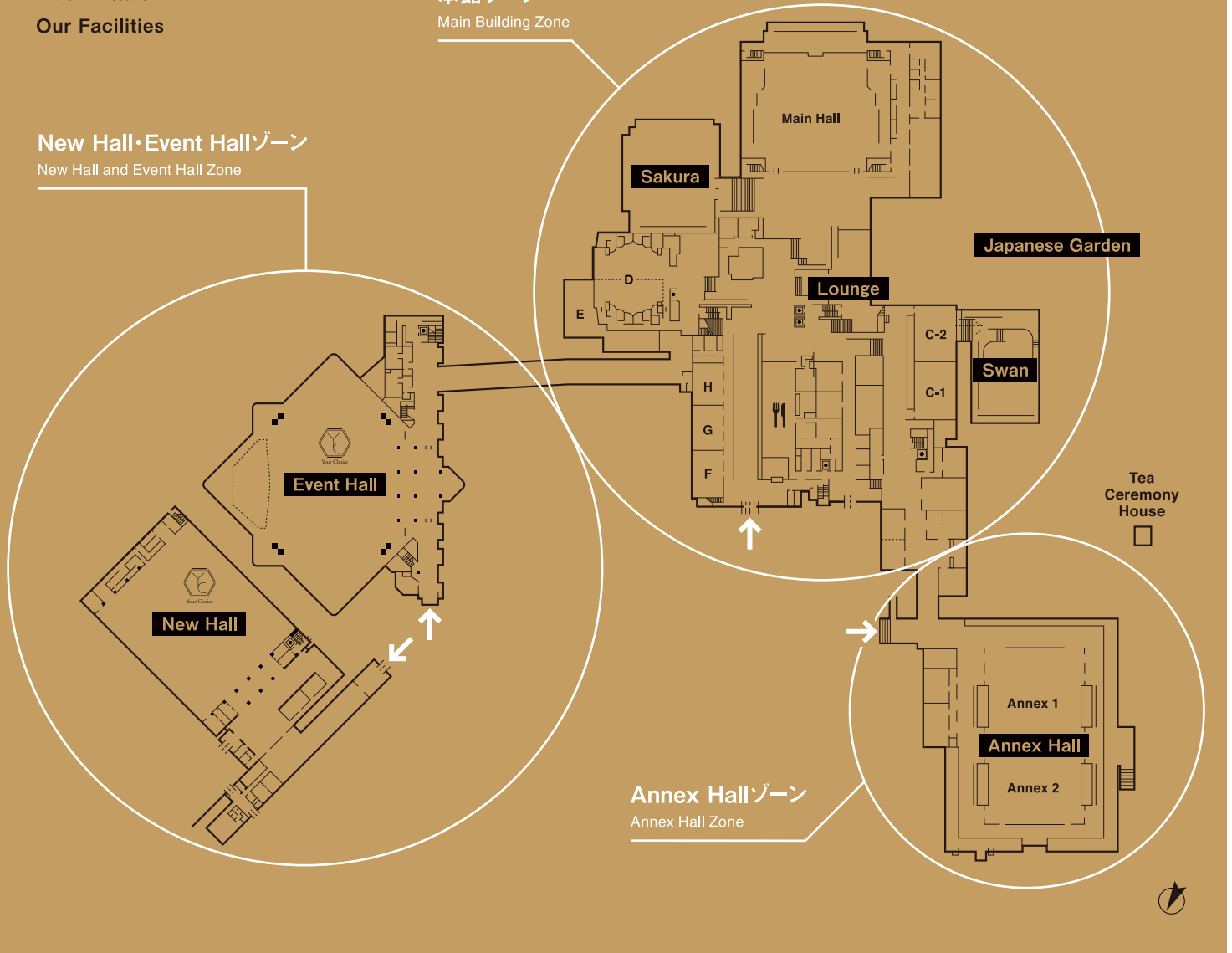

「えらべる」ケータリング・サービス

New HallとEvent Hallは、京都を代表するホテル
など5社から、お好みのケータリングが選べます。

“Your Choice” catering service

In the New Hall and Event Hall, you can choose among
catering services from five companies, including some
of Kyoto's top hotels.



Capacities
and
Dimensions

| | | | New Hall | Event Hall | Annex Hall | Sakura | Swan | Japanese Garden |
|------------|--------------|-------------------|----------|------------|------------|--------|------|-----------------|
| 面積 | Area | (m ²) | 2,000 | 3,000 | 1,500 | 805 | 540 | 5,000 ~ 10,000 |
| 天井高 | Ceiling High | (m) | 10 | 19.2 | 10 | 4.5 | 3.3 | — |
| 着席 | Banquet | (Seats) | 730 | 1,100 | 630 | 300 | 140 | — |
| 立食 | Reception | (Persons) | 1,500 | 2,000 | 1,000 | 500 | 300 | 2,000 |
| 長机 | Long Table | (Seats) | 1,500 | 1,700 | 1,000 | 450 | 140 | — |
| えらべるケータリング | Your Choice | | ○ | ○ | — | — | — | — |

*本館及びAnnex Hallのケータリングは、ICC Kyoto Catering Serviceが承ります。
*At Main Building and Annex Hall, our inhouse catering service handles cuisine and parties.

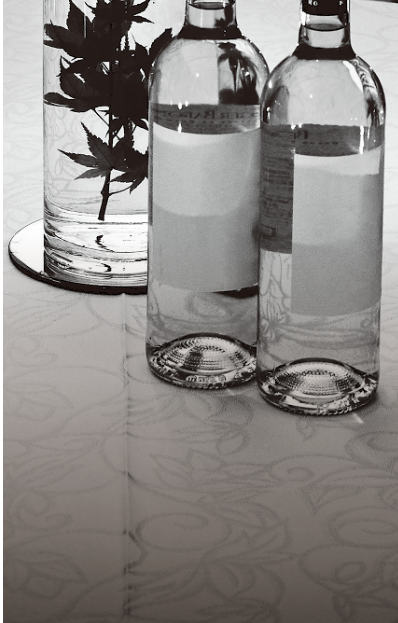

 ICC Kyoto

〒606-0001 京都市左京区宝ヶ池
電話：(075) 705-1229

Kyoto International
Conference Center (ICC Kyoto)
Takaragaike, Sakyo-ku, Kyoto,
606-0001 JAPAN
Phone:81-75-705-1229
<http://www.icckyo.or.jp>

